



REALTORS AGRO
FARMS & MANAGEMENT



ABOUT US



The Realtors Agro Management is a full-service agricultural management company, specializing in the strategic oversight of farmland, agribusiness properties, and rural estates. Our team of experts blends deep industry knowledge with a passion for sustainable farming, ensuring every property is optimized to its fullest potential.

With years of experience in agricultural and rural real estate, we work hand-in-hand with landowners, farmers, and investors to maximize productivity, enhance land value, and ensure long-term profitability, all while preserving natural resources and protecting the environment.

When it comes to irrigation, we adopt methods tailored to the land's needs: drip irrigation for water-scarce regions to conserve resources, and flood irrigation where water is abundant to maximize yield.

OUR SERVICES:



- Land & Water Analysis
- Land Levelling
- Pit Holes & Plantation Drenching
- Vermicompost / Fertilizers Application
- Plant Cultivation & Irrigation Management
- Year-Round Maintenance
- Ploughing (Godee)
- Spray & Crop Care
- Fruit Picking
- Transportation & Supply Chain Management
- Selling of Produce / Mandi Commission
- Return on Revenue

CLIENT RESPONSIBILITY:

- Land Provision
- Land Security
- Labor Accommodation
- Water Provision
- Initial Investment



FARM PLAN:

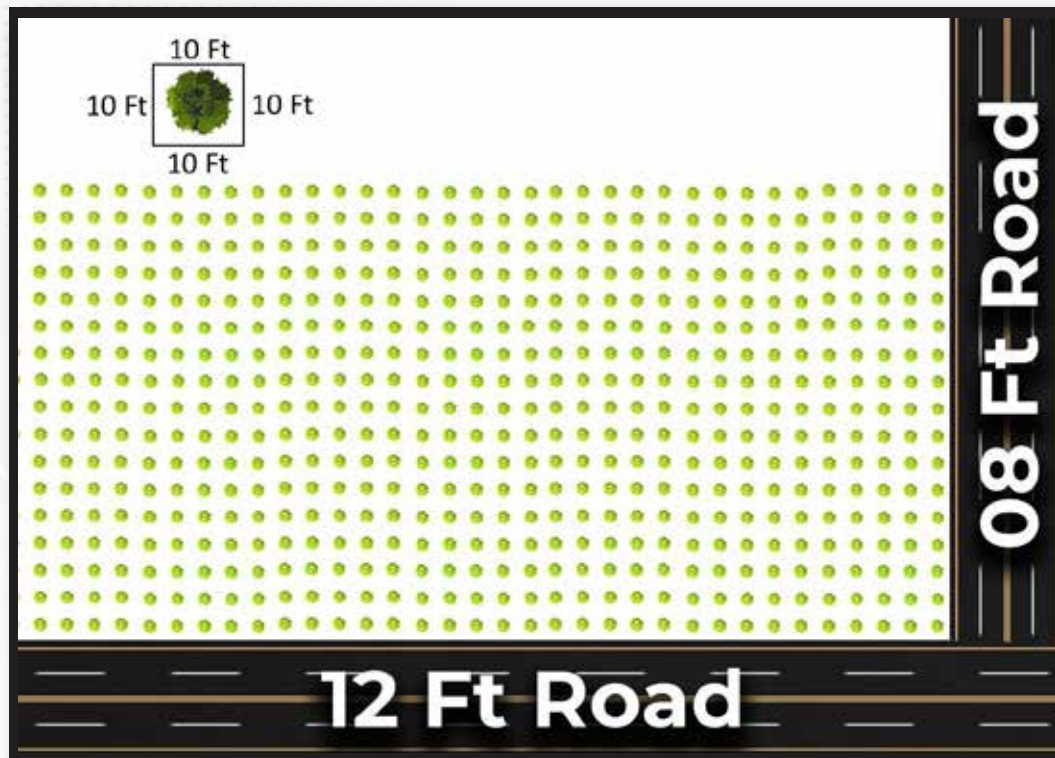

SOIL & WATER ANALYSIS REPORT:



LAND RESOURCES RESEARCH INSTITUTE
NATIONAL AGRICULTURE RESEARCH CENTRE
SOIL ADVISORY SERVICES
PARK ROAD, ISLAMABAD-45500, PAKISTAN

August 30, 2024

Subject: Soil Sample Analysis Report
(Mr. Anwar Khatri)

Sample ID	Lab ID	EC (1:1) dS/m	pH (1:1)	Soil Texture	Organic Matter %	Nitrate-Nitrogen mg/kg	Phosphorus mg/kg	Potassium mg/kg
2 ft	6082	0.19	8.51	Sandy Loam	0.21	0.24	2.18	51
5 ft	6083	0.15	8.71	Sandy Loam	0.31	0.11	0.57	48.6
7 ft	6084	0.19	8.55	Sandy Loam	0.40	0.13	1.25	48

Dr. Humair Ahmed
(Scientific Officer)

Generalized Guidelines for Interpretation of Soil Analysis data.

Measurement	Soil Test	Low	Marginal	Adequate
Nitrate (NO ₃ -N)	AB-DTPA	< 11	11-20	> 20
Phosphate (PO ₄ -P)	AB-DTPA	< 4	4-7	> 7
Potassium (K)	AB-DTPA	< 60	60-120	> 120

Tel: (92-51) 925-5060
Email: lrrr.narc@gmail.com

Fax: (92-51) 925-5034
Web: www.parc.gov.pk



LAND RESOURCES RESEARCH INSTITUTE
NATIONAL AGRICULTURE RESEARCH CENTRE
SOIL ADVISORY SERVICES
PARK ROAD, ISLAMABAD-45500, PAKISTAN

August 30, 2024

Water Analysis Report
Mr. Anwar Khatri

Sample Identification	LAB Code	pH	EC (dS/m)	TDS (mg l ⁻¹)	Na	CO ₃	HCO ₃	Cl	Ca+Mg	SAR	RSC
T001	6086	7.66	0.46	556.8	106	0	4.2	120	7	2.46	0

(Dr. Humair Ahmad)
Scientific Officer, NARC

Guidelines for irrigation water quality

Class	Quality	EC (dS m ⁻¹)	TDS (mg l ⁻¹)	SAR	RSC (meq l ⁻¹)
1	Fit	< 1.5	< 1000	< 7.5	< 2.0
2	Marginal	1.5-2.7	1000-1800	7.5-15	2.0-4.0
3	Unfit	> 2.7	> 1800	> 15	> 4.0

Tel: (92-51) 925-5060
Email: lrrr.narc@gmail.com

Fax: (92-51) 925-5034
Web: www.parc.gov.pk

INVESTMENT PLAN:

Per Acre Investment	No. of Acres	Total Investment Cost
5,000,000	10	50,000,000

COST OF AVOCADO PER ACRE 5,000,000

No. of Acres	Fruiting Year	yeild/plant in kg	No. of Plants	Total yeild in KG	Price per KG	Per Acre Returne	No. of Acres	Total revenue of 10 acres	Realtors share 50%	Owners share 50%
7 th year	1 nd year	15	400	6000	1000	6,000,000	10	60,000,000	30,000,000	30,000,000
8 th year	2 nd year	25	400	10,000	1000	10,000,000	10	100,000,000	50,000,000	50,000,000
9 th year	3 rd year	35	400	14,000	1000	14,000,000	10	140,000,000	70,000,000	70,000,000
10 th year	4 th year	45	400	18,000	1000	18,000,000	10	180,000,000	90,000,000	90,000,000
11 th year	5 th year	55	400	22,000	1000	22,000,000	10	220,000,000	110,000,000	110,000,000
									0	0
						70,000,000			350,000,000	350,000,000

Fruiting after 4 Years

AVOCADO PLANTATIONS AT TRG AGRO



At TRG Agro (The Realtors Group), The journey of avocado cultivation begins with planting healthy young saplings in fertile, well-drained soil, usually in warm, frost-free regions. Proper spacing, sunlight, and irrigation are vital for early growth, while mulching helps retain soil moisture and control weeds. As the trees mature, regular pruning shapes the canopy and promotes air circulation, while pest and disease management protect the crop. After 3 to 4 years, the trees begin to flower, and small fruits gradually develop, taking several months to mature.

Unlike many fruits, avocados ripen only after being picked, so harvesting is done carefully by hand or with special tools to prevent bruising. From plantation to harvesting, the process requires patience, consistent care, and sustainable practices, ultimately rewarding farmers with a highly nutritious fruit rich in healthy fats, vitamins, and minerals.





REALTORS AGRO

FARMS & MANAGEMENT

realtorsgoc.com