



REALTORS AGRO
FARMS & MANAGEMENT



ABOUT US



The Realtors Agro Management is a full-service agricultural management company, specializing in the strategic oversight of farmland, agribusiness properties, and rural estates. Our team of experts blends deep industry knowledge with a passion for sustainable farming, ensuring every property is optimized to its fullest potential.

With years of experience in agricultural and rural real estate, we work hand-in-hand with landowners, farmers, and investors to maximize productivity, enhance land value, and ensure long-term profitability, all while preserving natural resources and protecting the environment.

When it comes to irrigation, we adopt methods tailored to the land's needs: drip irrigation for water-scarce regions to conserve resources, and flood irrigation where water is abundant to maximize yield.

OUR SERVICES:



- Land & Water Analysis
- Land Levelling
- Pit Holes & Plantation Drenching
- Vermicompost / Fertilizers Application
- Plant Cultivation & Irrigation Management
- Year-Round Maintenance
- Ploughing (Godee)
- Spray & Crop Care
- Fruit Picking
- Transportation & Supply Chain Management
- Selling of Produce / Mandi Commission
- Return on Revenue



CLIENT RESPONSIBILITY:

- Land Provision
- Land Security
- Labor Accommodation
- Water Provision
- Initial Investment



FARM PLAN:

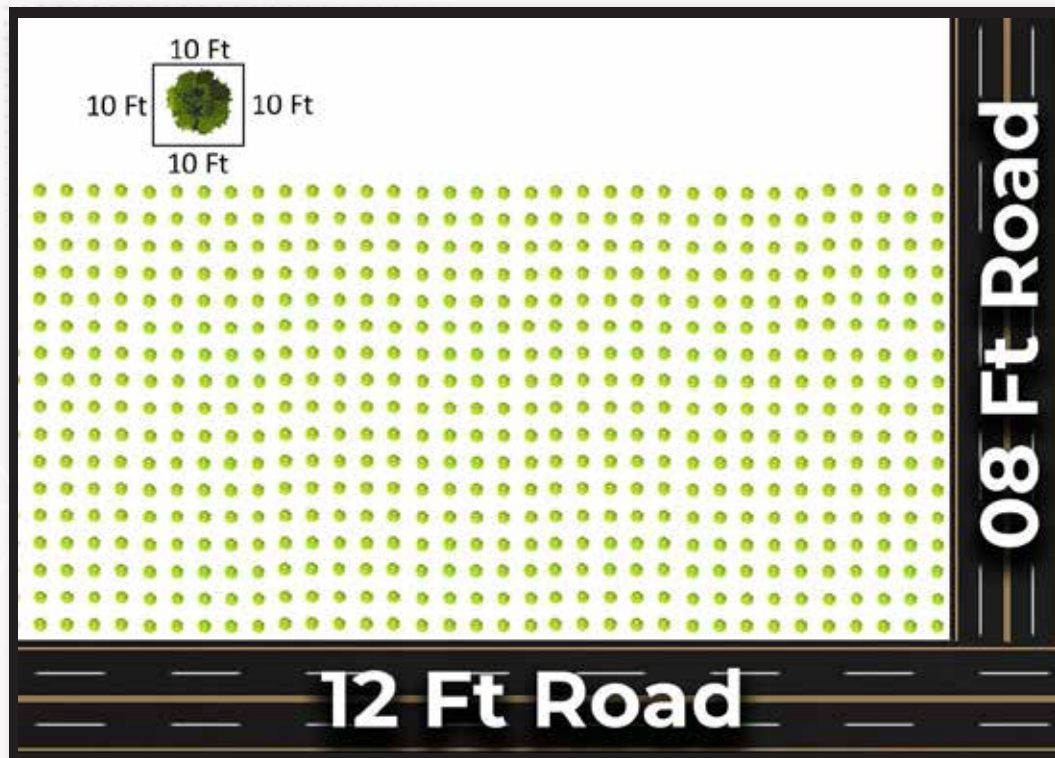

SOIL & WATER ANALYSIS REPORT:



LAND RESOURCES RESEARCH INSTITUTE
NATIONAL AGRICULTURE RESEARCH CENTRE
SOIL ADVISORY SERVICES
PARK ROAD, ISLAMABAD-45500, PAKISTAN

August 30, 2024

Subject: Soil Sample Analysis Report
(Mr. Anwar Khatri)

Sample ID	Lab ID	EC (1:1) dS/m	pH (1:1)	Soil Texture	Organic Matter %	Nitrate-Nitrogen	Phosphorus	Potassium
							mg/kg	
2 ft	6082	0.19	8.51	Sandy Loam	0.21	0.24	2.18	51
5 ft	6083	0.15	8.71	Sandy Loam	0.31	0.11	0.57	48.6
7 ft	6084	0.19	8.55	Sandy Loam	0.40	0.13	1.25	48



Dr. Humair Ahmed
(Scientific Officer)

Generalized Guidelines for Interpretation of Soil Analysis data.

Measurement	Soil Test	Low	Marginal	Adequate
Nitrate (NO ₃ -N)	AB-DTPA	< 11	11-20	> 20
Phosphate (PO ₄ -P)	AB-DTPA	< 4	4-7	> 7
Potassium (K)	AB-DTPA	< 60	60-120	> 120

Tel: (92-51) 925-5060
Email: lrr.narc@gmail.com

Fax: (92-51) 925-5034
Web: www.parc.gov.pk



LAND RESOURCES RESEARCH INSTITUTE
NATIONAL AGRICULTURE RESEARCH CENTRE
SOIL ADVISORY SERVICES
PARK ROAD, ISLAMABAD-45500, PAKISTAN

August 30, 2024

Water Analysis Report
Mr. Anwar Khatri

Sample Identification	LAB Code	pH	EC (dS/m)	TDS (mg l ⁻¹)	Na	CO ₃	HCO ₃	Cl	Ca+Mg	SAR	RSC
T001	6086	7.66	0.46	556.8	106	0	4.2	120	7	2.46	0



(Dr. Humair Ahmed)
Scientific Officer, NARC

Guidelines for irrigation water quality

Class	Quality	EC (dS m ⁻¹)	TDS (mg l ⁻¹)	SAR	RSC (meq l ⁻¹)
1	Fit	< 1.5	< 1000	< 7.5	< 2.0
2	Marginal	1.5-2.7	1000-1800	7.5-15	2.0-4.0
3	Unfit	> 2.7	> 1800	> 15	> 4.0

Tel: (92-51) 925-5060
Email: lrr.narc@gmail.com

Fax: (92-51) 925-5034
Web: www.parc.gov.pk

INVESTMENT PLAN:

Per Acre Investment	No. of Acres	Total Investment Cost
800,000	10	8,000,000

BABOON HERBS FEASIBILITY

Total Investment on 10 of Acres	8,000,000
Cost per Acre	800,000
Per Acre Revenue	1,000,000
Total Revenue of Acres per year	10,000,000
2 nd Year (as above)	10,000,000
3 rd Year (as above)	10,000,000
4 th Year (as above)	10,000,000
5 th Year (as above)	10,000,000
Total sales in 5 Years	50,000,000

BABOON PLANTATIONS AT TRG AGRO



At TRG Agro (The Realtors Group), Baboon Herbs cultivation stands as a sustainable and high-demand investment. Known for their medicinal and therapeutic properties, Baboon Herbs are widely used in pharmaceuticals, herbal supplements, teas, and natural remedies, making them a reliable source of consistent returns.

From plantation to harvesting, we apply modern agro-forestry and organic farming techniques to ensure optimal growth cycles and maximum potency. With increasing demand across local and international markets, Baboon Herbs farming at TRG Agro offers both profitability and environmental sustainability.



REALTORS AGRO
FARMS & MANAGEMENT





REALTORS AGRO

FARMS & MANAGEMENT

realtorsgoc.com