



REALTORS AGRO
FARMS & MANAGEMENT



ABOUT US



The Realtors Agro Management is a full-service agricultural management company, specializing in the strategic oversight of farmland, agribusiness properties, and rural estates. Our team of experts blends deep industry knowledge with a passion for sustainable farming, ensuring every property is optimized to its fullest potential.

With years of experience in agricultural and rural real estate, we work hand-in-hand with landowners, farmers, and investors to maximize productivity, enhance land value, and ensure long-term profitability, all while preserving natural resources and protecting the environment.

When it comes to irrigation, we adopt methods tailored to the land's needs: drip irrigation for water-scarce regions to conserve resources, and flood irrigation where water is abundant to maximize yield.

OUR SERVICES:



- Land & Water Analysis
- Land Levelling
- Pit Holes & Plantation Drenching
- Vermicompost / Fertilizers Application
- Plant Cultivation & Irrigation Management
- Year-Round Maintenance
- Ploughing (Godee)
- Spray & Crop Care
- Fruit Picking
- Transportation & Supply Chain Management
- Selling of Produce / Mandi Commission
- Return on Revenue

CLIENT RESPONSIBILITY:

- Land Provision
- Land Security
- Labor Accommodation
- Water Provision
- Initial Investment



FARM PLAN:

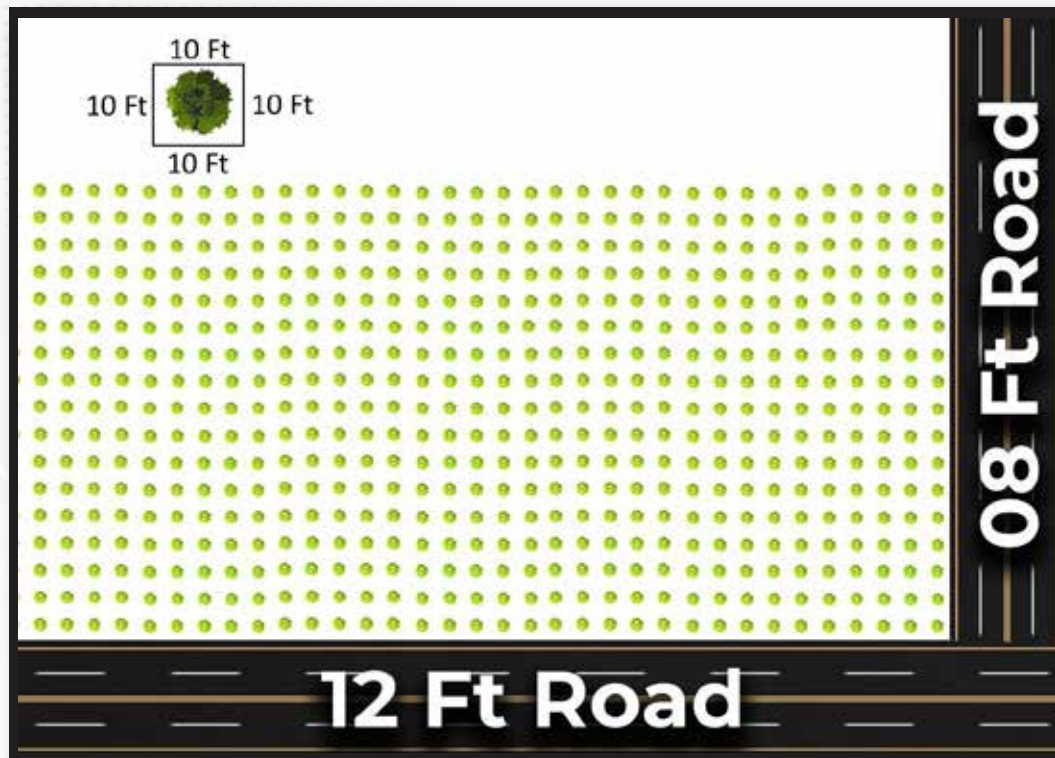

SOIL & WATER ANALYSIS REPORT:



LAND RESOURCES RESEARCH INSTITUTE
NATIONAL AGRICULTURE RESEARCH CENTRE
SOIL ADVISORY SERVICES
PARK ROAD, ISLAMABAD-45500, PAKISTAN

August 30, 2024

Subject: Soil Sample Analysis Report
(Mr. Anwar Khatri)

Sample ID	Lab ID	EC (1:1) dS/m	pH (1:1)	Soil Texture	Organic Matter %	Nitrate-Nitrogen	Phosphorus	Potassium
							mg/kg	
2 ft	6082	0.19	8.51	Sandy Loam	0.21	0.24	2.18	51
5 ft	6083	0.15	8.71	Sandy Loam	0.31	0.11	0.57	48.6
7 ft	6084	0.19	8.55	Sandy Loam	0.40	0.13	1.25	48

Dr. Humair Ahmed
(Scientific Officer)

Generalized Guidelines for Interpretation of Soil Analysis data:

Measurement	Soil Test	Low	Marginal	Adequate
Nitrate (NO ₃ -N)	AB-DTPA	< 11	11-20	> 20
Phosphate (PO ₄ -P)	AB-DTPA	< 4	4-7	> 7
Potassium (K)	AB-DTPA	< 60	60-120	> 120

Tel: (92-51) 925-5060
Email: lrrr.narc@gmail.com

Fax: (92-51) 925-5034
Web: www.parc.gov.pk



LAND RESOURCES RESEARCH INSTITUTE
NATIONAL AGRICULTURE RESEARCH CENTRE
SOIL ADVISORY SERVICES
PARK ROAD, ISLAMABAD-45500, PAKISTAN

August 30, 2024

Water Analysis Report
Mr. Anwar Khatri

Sample Identification	LAB Code	pH	EC (dS/m)	TDS (mg l ⁻¹)	Na	CO ₃	HCO ₃	Cl	Ca+Mg	SAR	RSC
T001	6086	7.66	0.46	556.8	106	0	4.2	120	7	2.46	0

(Dr. Humair Ahmad)
Scientific Officer, NARC

Guidelines for irrigation water quality

Class	Quality	EC (dS m ⁻¹)	TDS (mg l ⁻¹)	SAR	RSC (meq l ⁻¹)
1	Fit	< 1.5	< 1000	< 7.5	< 2.0
2	Marginal	1.5-2.7	1000-1800	7.5-15	2.0-4.0
3	Unfit	> 2.7	> 1800	> 15	> 4.0

Tel: (92-51) 925-5060
Email: lrrr.narc@gmail.com

Fax: (92-51) 925-5034
Web: www.parc.gov.pk

INVESTMENT PLAN:

Per Acre Investment	No. of Acres	Total Investment Cost
400,000	15	6,000,000

CASTOR BEAN FEASIBILITY

Total Investment of Acres			6,000,000
Cost per Acre			400,000
Revenue of the first two crops in the first year per acre			400,000
Revenue of the remaining eight crops per year per acre			300,000
Cultivation Months	Yeild/Acre	No. of Acre	Total Revenue
Feb to June	200,000	15	300,000
July to November	200,000	15	300,000
Total Revenue per Year		15	4,500,000
2 nd Year		15	4,500,000
3 rd Year		15	4,500,000
4 th Year		15	4,500,000
5 th Year		15	4,500,000
Total Revenue of 5 Year			22,500,000

CASTOR BEAN PLANTATION AT TRG AGRO



At TRG Agro, Castor Beans cultivation stands as a sustainable and high-demand investment. Rich in oil content and industrial value, Castor Beans are widely used in pharmaceuticals, cosmetics, lubricants, and bio-based products, making them a reliable source of consistent returns.

From plantation to harvesting, we apply modern agro-forestry and scientific farming techniques to ensure optimal growth cycles and maximum yield. With its growing demand across local and international markets, Castor Beans farming at TRG Agro offers both profitability and environmental sustainability.





REALTORS AGRO

FARMS & MANAGEMENT

realtorsgoc.com