



REALTORS AGRO
FARMS & MANAGEMENT



ABOUT US



The Realtors Agro Management is a full-service agricultural management company, specializing in the strategic oversight of farmland, agribusiness properties, and rural estates. Our team of experts blends deep industry knowledge with a passion for sustainable farming, ensuring every property is optimized to its fullest potential.

With years of experience in agricultural and rural real estate, we work hand-in-hand with landowners, farmers, and investors to maximize productivity, enhance land value, and ensure long-term profitability, all while preserving natural resources and protecting the environment.

When it comes to irrigation, we adopt methods tailored to the land's needs: drip irrigation for water-scarce regions to conserve resources, and flood irrigation where water is abundant to maximize yield.

OUR SERVICES:



- Land & Water Analysis
- Land Levelling
- Pit Holes & Plantation Drenching
- Vermicompost / Fertilizers Application
- Plant Cultivation & Irrigation Management
- Year-Round Maintenance
- Ploughing (Godee)
- Spray & Crop Care
- Fruit Picking
- Transportation & Supply Chain Management
- Selling of Produce / Mandi Commission
- Return on Revenue

CLIENT RESPONSIBILITY:

- Land Provision
- Land Security
- Labor Accommodation
- Water Provision
- Initial Investment



FARM PLAN:

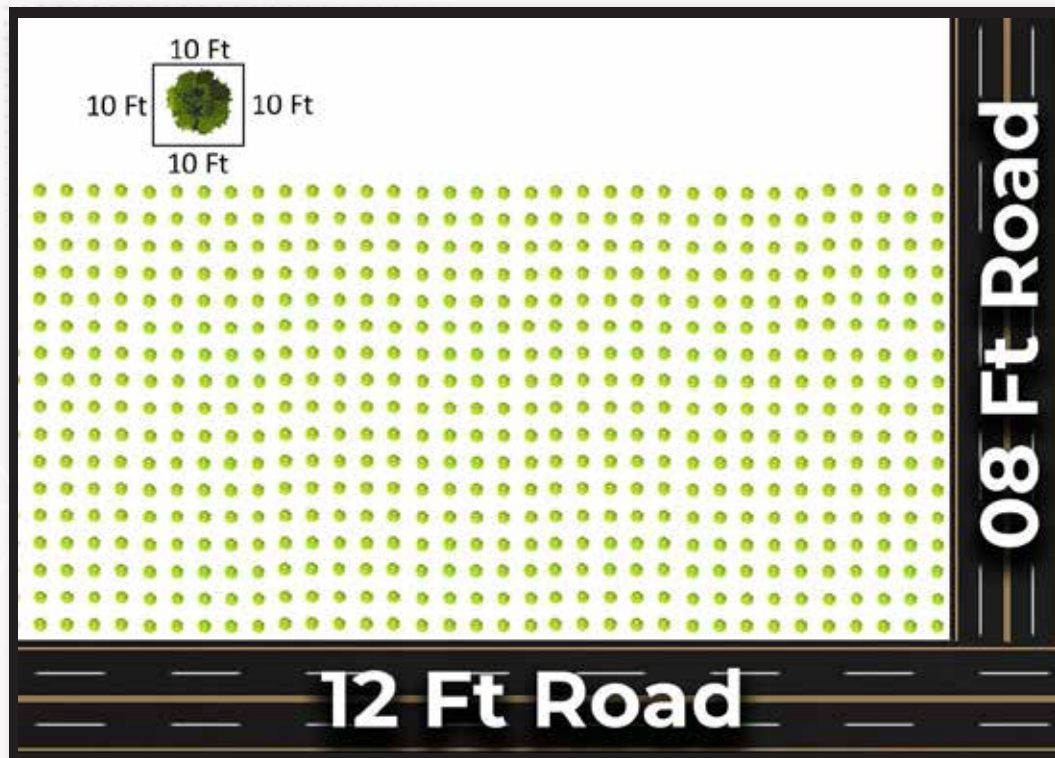

SOIL & WATER ANALYSIS REPORT:



LAND RESOURCES RESEARCH INSTITUTE
NATIONAL AGRICULTURE RESEARCH CENTRE
SOIL ADVISORY SERVICES
PARK ROAD, ISLAMABAD-45500, PAKISTAN

August 30, 2024

Subject: Soil Sample Analysis Report
(Mr. Anwar Khatri)

Sample ID	Lab ID	EC (1:1) dS/m	pH (1:1)	Soil Texture	Organic Matter %	Nitrate-Nitrogen	Phosphorus	Potassium
							mg/kg	
2 ft	6082	0.19	8.51	Sandy Loam	0.21	0.24	2.18	51
5 ft	6083	0.15	8.71	Sandy Loam	0.31	0.11	0.57	48.6
7 ft	6084	0.19	8.55	Sandy Loam	0.40	0.13	1.25	48

Dr. Humair Ahmed
(Scientific Officer)

Generalized Guidelines for Interpretation of Soil Analysis data:

Measurement	Soil Test	Low	Marginal	Adequate
Nitrate (NO ₃ -N)	AB-DTPA	< 11	11-20	> 20
Phosphate (PO ₄ -P)	AB-DTPA	< 4	4-7	> 7
Potassium (K)	AB-DTPA	< 60	60-120	> 120

Tel: (92-51) 925-5060
Email: lrrr.narc@gmail.com

Fax: (92-51) 925-5034
Web: www.parc.gov.pk



LAND RESOURCES RESEARCH INSTITUTE
NATIONAL AGRICULTURE RESEARCH CENTRE
SOIL ADVISORY SERVICES
PARK ROAD, ISLAMABAD-45500, PAKISTAN

August 30, 2024

Water Analysis Report
Mr. Anwar Khatri

Sample Identification	LAB Code	pH	EC (dS/m)	TDS (mg l ⁻¹)	Na	CO ₃	HCO ₃	Cl	Ca+Mg	SAR	RSC
T001	6086	7.66	0.46	556.8	106	0	4.2	120	7	2.46	0

(Dr. Humair Ahmad)
Scientific Officer, NARC

Guidelines for irrigation water quality

Class	Quality	EC (dS m ⁻¹)	TDS (mg l ⁻¹)	SAR	RSC (meq l ⁻¹)
1	Fit	< 1.5	< 1000	< 7.5	< 2.0
2	Marginal	1.5-2.7	1000-1800	7.5-15	2.0-4.0
3	Unfit	> 2.7	> 1800	> 15	> 4.0

Tel: (92-51) 925-5060
Email: lrrr.narc@gmail.com

Fax: (92-51) 925-5034
Web: www.parc.gov.pk

INVESTMENT PLAN:

Per Acre Investment	No. of Acres	Total Investment Cost
1,600,000	10	16,000,000

1.6 MILLION PER ACRE COST

Plant Age	Years	No. of Plants/ Acre	Fruit/ Plant kg	Total kg / Acre	Per kg Price	Per Acre Revenue	No. of Acres	Total Revenue	Owners share 50%	Realtors share 50%
3 year	1 year	1600	20	32,000	80	2,560,000	10	25,600,000	12,800,000	12,800,000
4 year	2 year	1600	40	64,000	80	5,120,000	10	51,200,000	25,600,000	25,600,000
5 year	3 year	1600	60	96,000	80	7,680,000	10	76,800,000	38,400,000	38,400,000
6 year	4 year	1600	80	128,000	80	10,240,000	10	102,400,000	51,200,000	51,200,000
7 year	5 year	1600	100	160,000	80	12,800,000	10	128,000,000	64,000,000	64,000,000
						38,400,000		384,000,000	192,000,000	192,000,000

Return after 4 Years

GUAVA PLANTATION AT TRG AGRO



At TRG Agro, Guava cultivation stands as a sustainable and high-demand investment. Packed with rich flavor, high nutritional value, and medicinal benefits, Guava is widely used in fresh consumption, juices, jams, and processed food industries, making it a reliable source of consistent returns.

From plantation to harvesting, we apply modern orchard management and scientific farming techniques to ensure optimal growth cycles and maximum yield. With its growing demand across local and international markets, Guava farming at TRG Agro offers both profitability and environmental sustainability.







REALTORS AGRO

FARMS & MANAGEMENT

realtorsgoc.com