



**REALTORS AGRO**  
FARMS & MANAGEMENT



# ABOUT US



The Realtors Agro Management is a full-service agricultural management company, specializing in the strategic oversight of farmland, agribusiness properties, and rural estates. Our team of experts blends deep industry knowledge with a passion for sustainable farming, ensuring every property is optimized to its fullest potential.

With years of experience in agricultural and rural real estate, we work hand-in-hand with landowners, farmers, and investors to maximize productivity, enhance land value, and ensure long-term profitability, all while preserving natural resources and protecting the environment.

When it comes to irrigation, we adopt methods tailored to the land's needs: drip irrigation for water-scarce regions to conserve resources, and flood irrigation where water is abundant to maximize yield.



# OUR SERVICES:

---



- Land & Water Analysis
- Land Levelling
- Pit Holes & Plantation Drenching
- Vermicompost / Fertilizers Application
- Plant Cultivation & Irrigation Management
- Year-Round Maintenance
- Ploughing (Godee)
- Spray & Crop Care
- Fruit Picking
- Transportation & Supply Chain Management
- Selling of Produce / Mandi Commission
- Return on Revenue

# CLIENT RESPONSIBILITY:

- Land Provision
- Land Security
- Labor Accommodation
- Water Provision
- Initial Investment





# FARM PLAN:

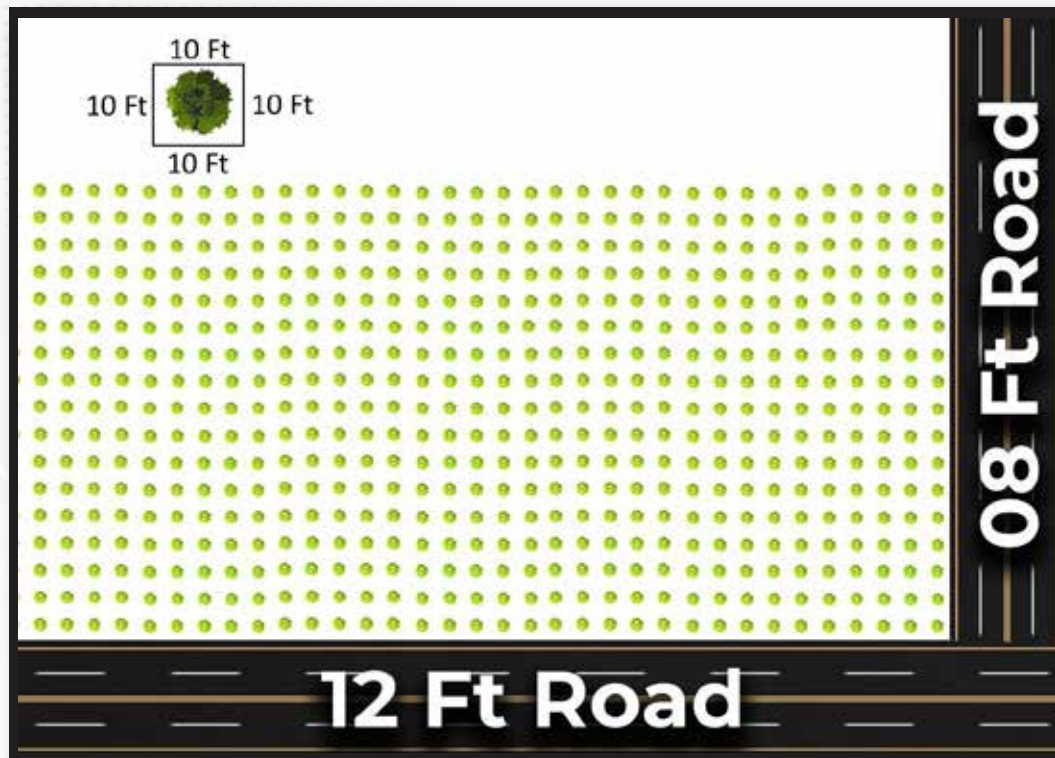

# SOIL & WATER ANALYSIS REPORT:



**LAND RESOURCES RESEARCH INSTITUTE**  
NATIONAL AGRICULTURE RESEARCH CENTRE  
SOIL ADVISORY SERVICES  
PARK ROAD, ISLAMABAD-45500, PAKISTAN

August 30, 2024

Subject: Soil Sample Analysis Report  
(Mr. Anwar Khatri)

Sample ID	Lab ID	EC (1:1) dS/m	pH (1:1)	Soil Texture	Organic Matter %	Nitrate-Nitrogen mg/kg	Phosphorus mg/kg	Potassium mg/kg
2 ft	6082	0.19	8.51	Sandy Loam	0.21	0.24	2.18	51
5 ft	6083	0.15	8.71	Sandy Loam	0.31	0.11	0.57	48.6
7 ft	6084	0.19	8.55	Sandy Loam	0.40	0.13	1.25	48

Dr. Humair Ahmed  
(Scientific Officer)

Generalized Guidelines for Interpretation of Soil Analysis data.

Measurement	Soil Test	Low	Marginal	Adequate
Nitrate (NO <sub>3</sub> -N)	AB-DTPA	< 11	11-20	> 20
Phosphate (PO <sub>4</sub> -P)	AB-DTPA	< 4	4-7	> 7
Potassium (K)	AB-DTPA	< 60	60-120	> 120

Tel: (92-51) 925-5060  
Email: [lrrr.narc@gmail.com](mailto:lrrr.narc@gmail.com)

Fax: (92-51) 925-5034  
Web: [www.parc.gov.pk](http://www.parc.gov.pk)



**LAND RESOURCES RESEARCH INSTITUTE**  
NATIONAL AGRICULTURE RESEARCH CENTRE  
SOIL ADVISORY SERVICES  
PARK ROAD, ISLAMABAD-45500, PAKISTAN

August 30, 2024

Water Analysis Report  
Mr. Anwar Khatri

Sample Identification	LAB Code	pH	EC (dS/m)	TDS (mg l <sup>-1</sup> )	Na	CO <sub>3</sub>	HCO <sub>3</sub>	Cl	Ca+Mg	SAR	RSC
T001	6086	7.66	0.46	556.8	106	0	4.2	120	7	2.46	0

(Dr. Humair Ahmad)  
Scientific Officer, NARC

Guidelines for irrigation water quality

Class	Quality	EC (dS m <sup>-1</sup> )	TDS (mg l <sup>-1</sup> )	SAR	RSC (meq l <sup>-1</sup> )
1	Fit	< 1.5	< 1000	< 7.5	< 2.0
2	Marginal	1.5-2.7	1000-1800	7.5-15	2.0-4.0
3	Unfit	> 2.7	> 1800	> 15	> 4.0

Tel: (92-51) 925-5060  
Email: [lrrr.narc@gmail.com](mailto:lrrr.narc@gmail.com)

Fax: (92-51) 925-5034  
Web: [www.parc.gov.pk](http://www.parc.gov.pk)

# INVESTMENT PLAN:

Per Acre Cost	No. of Acres	Total no. of Plants	Total Investment Cost
1,600,000	1000	10	16,000,000

# RETURN ON INVESTMENT:

No. of Plants per acre	No. of Acres	Total no. of Plants	Per Plant estimated Sale Price	Total Sale	Owner Share	Realtors Agro Share
1000	10	10,000	15,000	150,000,000	75,000,000	75,000,000

**Harvesting will be in every 2 years from the Date of Cultivation.**



# POPLAR TREE PLANTATIONS AT TRG AGRO

---



At TRG Agro (The Realtors Group), Poplar tree cultivation stands as a sustainable and high-demand investment. Fast-growing and versatile, Poplar is widely used in furniture, paper, matchstick, and construction industries, making it a reliable source of consistent returns.

From plantation to harvesting, we apply modern agro-forestry techniques to ensure optimal growth cycles and maximum yield. With its increasing demand across local and international markets, Poplar farming at TRG Agro offers both profitability and environmental sustainability.





**REALTORS AGRO**  
FARMS & MANAGEMENT







# REALTORS AGRO

## FARMS & MANAGEMENT

[realtorsgoc.com](http://realtorsgoc.com)